

## Modular Preparation 900 mm Passthrough Hot Cupboard with Hinged Doors

ITEM # \_\_\_\_\_

MODEL # \_\_\_\_\_

NAME # \_\_\_\_\_

SIS # \_\_\_\_\_

AIA # \_\_\_\_\_



121835 (TER2PE9DA)

Hot Cupboard with 2+2  
hinged doors, pass-through,  
900mm

### Short Form Specification

#### Item No. \_\_\_\_\_

Constructed entirely in 304 AISI stainless steel. Front and rear longitudinal stainless steel c-channel reinforcement. Internal and external side panels with sound deadening reinforcements to strengthen structure. Doors incorporate sound deadening internal panels and are fitted with 304 AISI stainless steel hinges allowing an opening of 180° degrees. 150mm height-adjustable (0/+90mm) oversized feet (65x65mm) can be removed for masonry installation. 45° degree internal side corner junction system. 304 AISI middle shelf, with inner double fold to eliminate gaps between sides and back, height-adjustable in 3 positions with a stainless steel support to avoid twisting. Hot cupboard with channeled ventilation system (2-way output) to allow for a correct airflow and even temperature within the storage area. Fan-assisted heating via armoured elements assures temperature ranges from 30° to 90°C. Removable control panel with mechanical thermostat, green ON/OFF indicator light and orange indicator light for heating element operation.

### Main Features

- Masonry installation possible by simply removing feet.
- Extremely easy to clean thanks to the smooth edges.
- Model specific to keep dishes warm.

### Construction

- Sound deadening reinforcements between internal and external side panels to strengthen structure.
- Mounted on 150 mm height adjustable (0/+90 mm) oversized (65x65 mm) feet.
- Internal sides supporting the structure to have 45° degrees internal side corners junction system.
- 30 mm high middle-shelf in AISI 304 stainless steel, height-adjustable in 3 positions, with inner double fold to eliminate gaps between sides and back.
- Supplied with a channeled ventilation system (2 way outputs) which allows a correct airflow and even temperature inside the storage area.
- Fan assisted heating via amored elements ensuring temperature range from 30° to 90°C.
- Detachable control panel with mechanical thermostat and on/off green and orange indicator light for heating element operation.
- Hinged door with sound deadening internal panels, fitted with 304 AISI stainless steel hinges on the inner sides, allows a 180° degree opening.
- Constructed entirely in AISI 304 Stainless Steel with Scotch Brite finish.

### Optional Accessories

- Stainless steel plinth, 900mm PNC 855825 ☐
- Stainless steel plinth for end elements, central installation, 700mm depth PNC 855838 ☐

APPROVAL: \_\_\_\_\_



**Electrolux**  
PROFESSIONAL

## Modular Preparation 900 mm Passthrough Hot Cupboard with Hinged Doors

Front

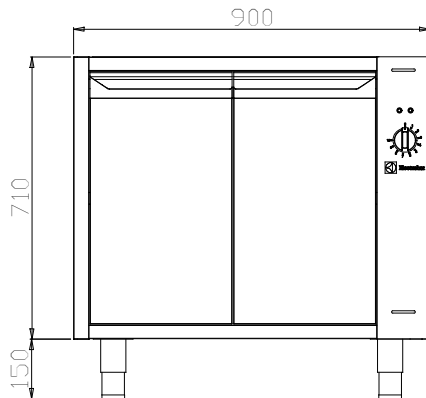

Side

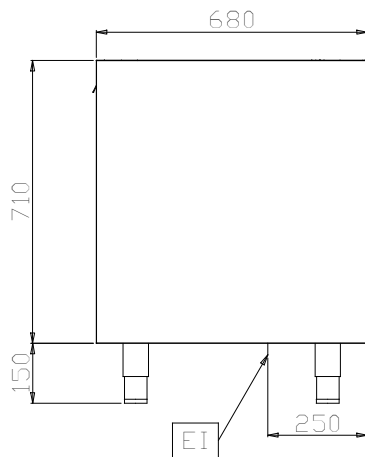

EI = Electrical inlet (power)

Top

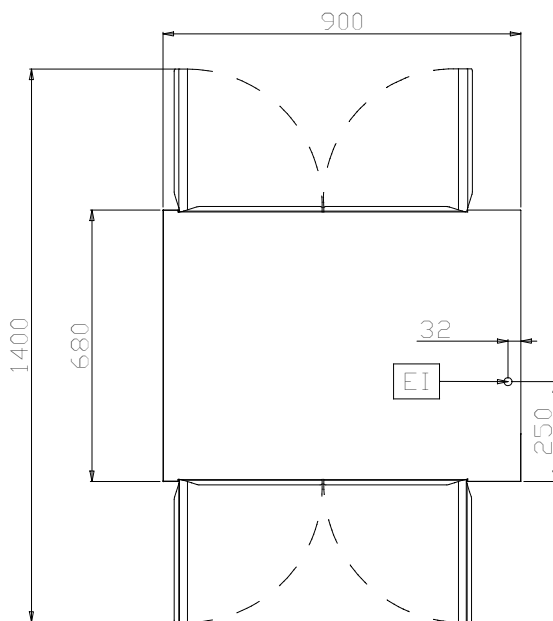

### Electric

Supply voltage:	230 V/1 ph/50/60 Hz
Total Watts:	1.6 kW

### Key Information:

Cabinet width:	730 mm
Cabinet depth:	610 mm
Cabinet height:	620 mm
External dimensions, Width:	900 mm
External dimensions, Depth:	680 mm
External dimensions, Height:	860 mm
Net weight:	28 kg



Modular Preparation  
900 mm Passthrough Hot Cupboard with Hinged Doors

The company reserves the right to make modifications to the products without prior notice. All information correct at time of printing.

2025.06.30